



***SCIENTIFIC PROGRAM
EXHIBIT HALL SCHEDULE**

THURSDAY, AUGUST 19, 2010
Exhibit hall move-in: 12:00pm – 8:00pm

FRIDAY, AUGUST 20, 2010
Exhibiting Hours
6:30am – 7:00am (Breakfast)
10:15am – 10:45am (Break)
2:45pm – 3:15pm (Break)

SATURDAY, AUGUST 21, 2010
Exhibiting Hours
6:30am – 7:00am (Breakfast)
9:45am – 10:15am (Break)
2:15pm – 2:45pm (Break)
Dismantling and move out: 5:00pm – 8:00pm

LUNCHESES –
Feel free to dine in the Grand Hall with participants and faculty where you can talk in a more relaxed setting.

For more information visit us on the web:

www.sprgs.org



Build Relationships

EXHIBITOR OPPORTUNITIES

at the
**19TH International
Pelvic Reconstructive and
Vaginal Surgery Conference**

August 19-21, 2010
St. Louis, Missouri

**CONNECT YOUR BUSINESS TO TOP
GYNECOLOGISTS FROM AROUND THE WORLD
AND UP-AND-COMING RESIDENTS AND FELLOWS.**

The Society of Pelvic Reconstructive Surgeons (SPRS) is pleased to offer your company the opportunity to exhibit at our 19th International Pelvic Reconstructive and Vaginal Surgery Conference. This scientific meeting will give you and your company the chance to have two days to talk with physician leaders in gynecological surgery from the United States and abroad.

EXHIBITORS will receive:

- The opportunity for two representatives from their company to interact with 100+ gynecologists and urogynecologists during the Exhibit Hall hours.*
- One 8 ft. table during the Scientific Program on Friday and Saturday. Additional tables may be purchased.
- Advertisement of your company logo listed on the SPRS corporate sponsors page and monthly email newsletter for one year.
- 1 post conference attendee mailing list in Excel format.
- Continental breakfast, lunch and break snacks on Friday and Saturday.

Educational Grant Opportunities

Please complete and return the attached Letter of Agreement

SPRS is soliciting educational grants to support our meeting. In addition to a grant to support the scientific sessions we are offering companies the opportunity to underwrite the various social functions during the meeting. Per ACCME regulations, this support must be done via an educational grant. Recognition of your sponsorship will be printed in the final program and at the specific social activity.

The following support opportunities are available:

- Refreshment Break** (4) \$2000 each
- Continental Breakfast** (3) \$4000 each
- Lunch** (2) \$6000 each
- Opening Reception** \$4000
- Educational Grant to support the Scientific Meeting** (any amount)

CONTRACT TERMS AND CONDITIONS

- Conditions of Exhibitors and Sponsorship:** Eligibility to participate at the 2010 International Pelvic Reconstructive and Vaginal Surgery Conference (IPRVSC) is determined solely by the producers. Exhibitors and sponsors may not assign, sublicense, or apportion any part of their exhibit space to a third party without the written consent of SPRS.
- Exhibitors/sponsor must wear their conference name badge at all times** while in the conference, exhibit and meal areas. Name badges may not be reassigned to other persons.
- Exhibitors/sponsors may attend conference sessions, on a space-available basis**, using the seats in the rear row(s) only. Exhibitors/sponsors may not participate in the conference proceedings by speaking, commenting, or asking questions.
- Exhibitors/sponsors may not hold** any educational, informational, or social event for attendees of the 2010 IPRVSC, except those contracted through 2010 IPRVSC.
- Exhibitors/sponsors must be present at their assigned table during all Scientific Program breakouts. **Dismantling of exhibits before 5:00 p.m. on Saturday, August 21, 2010, will result in a withdrawal of future invitations to the IPRVSC.**
- SPRS shall be entitled to terminate this Agreement forthwith**, close the exhibit, and remove the exhibitor's/sponsor's property from the exhibit/conference area at any time for failure by the exhibitor/sponsor or any of its officers, agents, employees, or other representative to perform, meet, and/or observe any term, condition, or rules set forth in these terms and conditions and such exhibitor/sponsor shall not be entitled to a refund of any payment.
- Cancellation of this contract must be in writing.** If cancellation occurs, applicant will be liable for payment on the following schedule:
 - Before June 1, 2010, applicant will be liable for 50% of the total fee.
 - After June 1, 2010, applicant will be liable for 100% of the total fee.

SPRS reserves the right to cancel the event on its own accord in the event of insufficient physician registration. If this occurs, the only liability 2010 IPRVSC will have is to refund all exhibitor sponsor payments received to date.
- Exhibitor Indemnification:** Exhibitors and their agents agree to protect, indemnify, defend and hold harmless SPRS and their respective employees, partners, and agents against all claims or liability, including but not limited to injuries and damages to persons or property, governmental charges or fines, and attorneys fees arising out of or caused by negligence or wrongful acts of the exhibitor or its agents or employees.
- Force Majeure:** The performance of this agreement by either party is subject to acts of God, war, terrorism, government regulation, disaster, fire, strikes, civil disorder, curtailment of transportation facilities, or other similar cause beyond the control of the parties making it inadvisable, illegal, impractical, or impossible to hold a successful meeting. This contract may be terminated without penalty for any one or more of such reasons by written notice from one party to the other.
- Acceptance of this application by SPRS constitutes a contract.** Exhibitor/Sponsor agrees to abide by the contract terms and conditions appearing on this form for the 2010 IPRVSC.



APPLICATION AND CONTRACT

Mail or fax this form with payment to:
 Sarah Daniels, SPRS, 3418 Charlack Ave., Ste. 615, St. Louis, MO 63114
 Tel: 314-302-3826 Fax: 314-827-0064

Upon receipt and approval of the application and contract, an exhibitor kit including hotel and shipping information will be sent to the contact listed below.

Company: _____ Contact Name: _____

Title: _____ E-mail: _____

Phone: _____ Fax: _____

Street: _____ City: _____

State: _____ Zip Code: _____

Authorized Signature: _____

Date: _____

✓	#	Item	Price
		Exhibitor Table, Scientific Program (2 reps/agents per table)	\$2000.00 ea.
		Additional representative/agent	\$1000.00 ea.
TOTAL DUE:			

For space assignment requests please see attached map.

(Space assignment is highly competitive, please submit your application early. Date of receipt of the exhibitor fee will be the determining factor in space assignment.)

50% of total fee must accompany all contracts submitted before June 1, 2010. The remaining balance of 50% is due July 1, 2010. 100% must accompany all contracts submitted after July 1, 2010.

AMEX MasterCard
 Visa Discover

Credit Card #: _____ Exp Date: _____

Name on Card: _____ Title: _____

Signature: _____ Date: _____

Check #: _____ enclosed. Make checks payable to SPRS Inc.

For SPRS Use Only			
Date RCVD _____	Space ASSGN _____	TOT Cost _____	SPRS IN _____

Contact Us: info@sprs.org Tel: (314) 302-3826
 www.sprs.org Fax: (314) 827-0064

Company Name: _____ Contact Name: _____

Space Assignments

Union Station Marriott, St. Louis, MO

The Exhibitor Hall will be held in Regency Ballroom B. If we reach capacity in Ballroom B, we will open Regency Ballroom A and a space assignment layout will be sent accordingly.

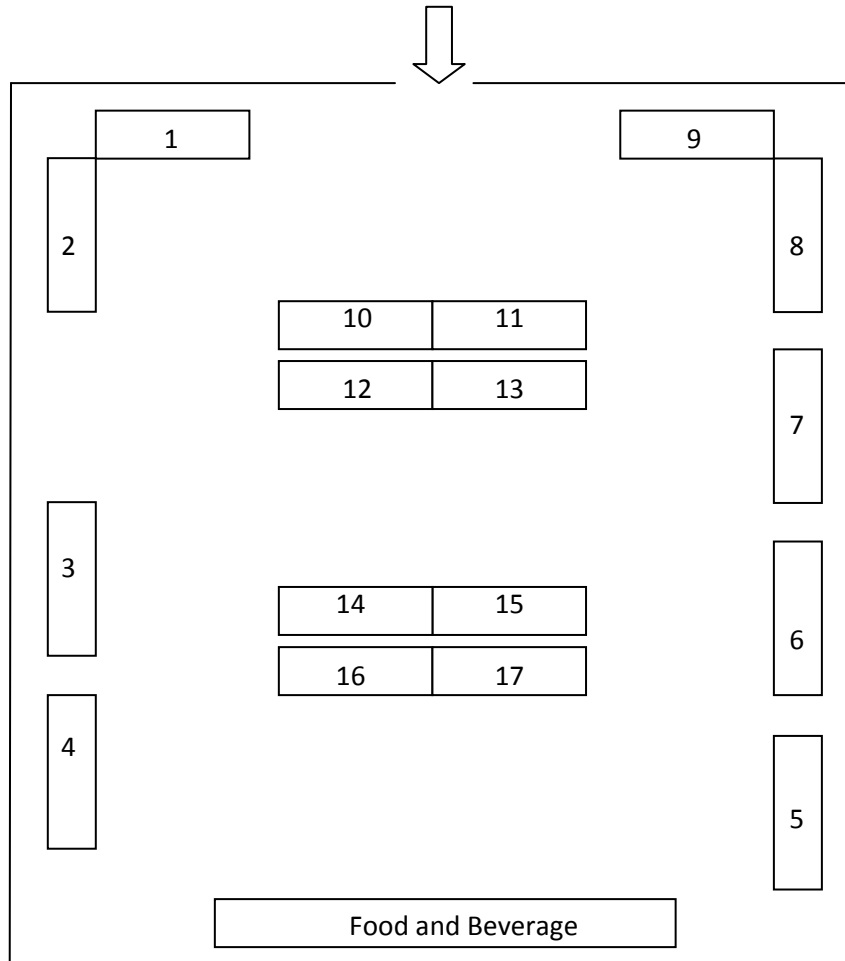

MEETING SPACES

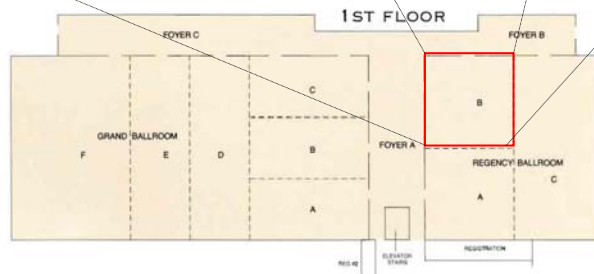

Please indicate your booth(s) preference in order of most desirable to less desirable.

Space assignment is highly competitive, please submit your application early. Receipt date of the exhibitor fee will be the determining factor in space assignment.

Choice 1: _____

Choice 2: _____

Choice 3: _____

For SPRS Use Only:

PMRCVD: _____ SPASN: _____ SPRS SIG: _____